

Soils Map

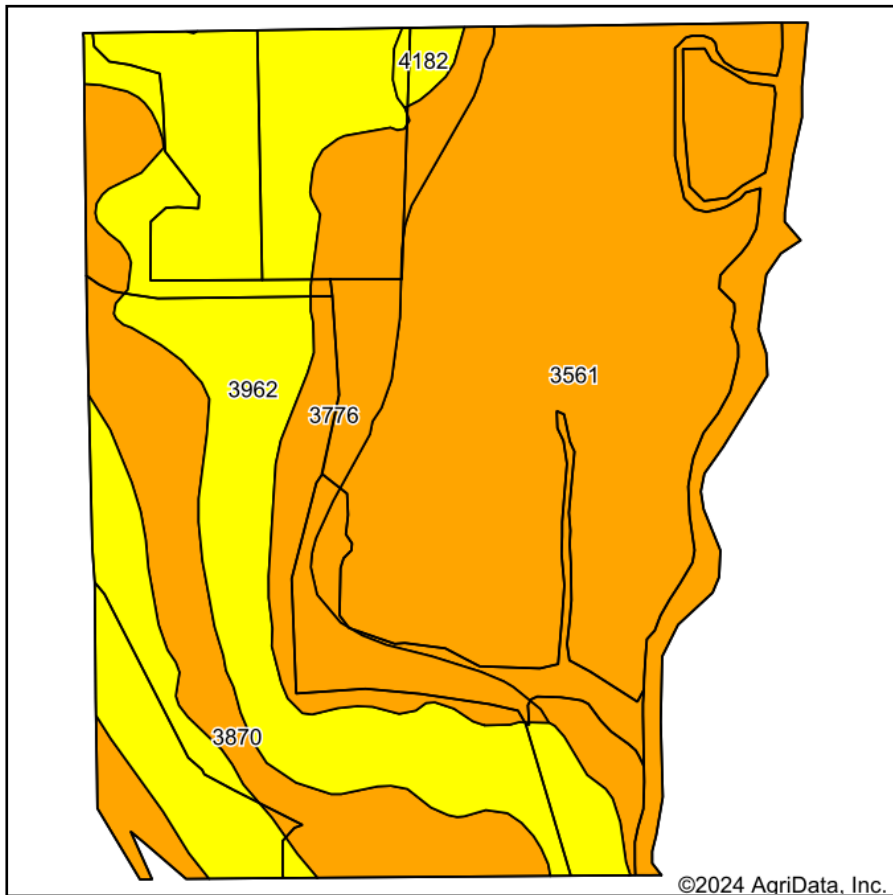

Soils data provided by USDA and NRCS.

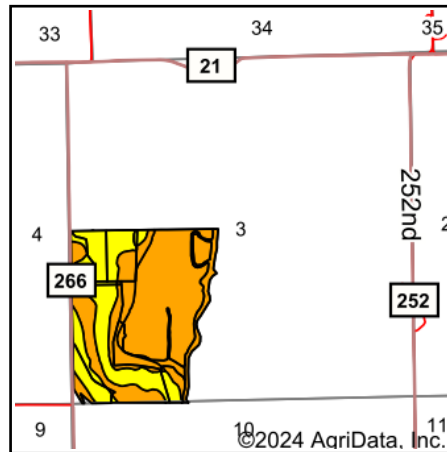

State: **Nebraska**
 County: **Seward**
 Location: **3-12N-3E**
 Township: **Precinct B**
 Acres: **122.64**
 Date: **10/2/2024**



Area Symbol: NE159, Soil Area Version: 23

Code	Soil Description	Acres	Percent of field	SRPG Legend	Non-Irr Class *c	Irr Class *c	SRPG	*n NCCPI Soybeans		
3561	Hobbs silt loam, occasionally flooded	57.45	46.9%		IIw	IIw	71	80		
3962	Hastings silty clay loam, 7 to 11 percent slopes, eroded	37.00	30.2%		IVe	IVe	65	56		
3870	Hastings silty clay loam, 3 to 7 percent slopes, eroded	13.75	11.2%		IIIe	IIIe	71	58		
3776	Muir silt loam, 1 to 3 percent slopes	13.53	11.0%		Ile	Ile	75	79		
4182	Longford silty clay loam, 7 to 11 percent slopes, eroded	0.91	0.7%		IVe	IVe	64	54		
Weighted Average							2.73	2.73	69.6	*n 70

*n: The aggregation method is "Weighted Average using all components"

*c: Using Capabilities Class Dominant Condition Aggregation Method